

REVISED LIGHTING FIXTURE SCHEDULE

- F-1 RAUMBUSCH
- F-2
- F-3 STEEBER SWIVEL BASE #8 WITH 300" A-40 LAMP.
- F-4 ORNATE EXHIBIT #105 WITH DIRECTIONAL ARROW AS SHOWN. 3" WHITE LETTERS ON GREEN FIELD & 3-35" LAMPS ON ALTERNATE CIRCUITS.
- F-5 BUTH A-1994
- F-6 LITECRAFT 602 A, BRASS FINISH - WITH 150 W. A-40 FLOOD LAMP WITH CLIP-ON LOUVER.
- F-7 SMITHCRAFT DLR 3-86-A30, MOUNTED ON BARNSTE TYPE AT HANGERS 8' FT ABOVE FLOOR WITH DELUXE SHIELDING.
- F-8 LITECRAFT 655B/36-3, BRASS WITH PERFORATIONS WITH CLIP-ON LOUVERS FOR LARGE CONES.
- F-9 WHEELER #0214 H.
- F-10 HUBBELL #489 PLOT RECEPTACLE WITH #22 RUBY BULL'S EYE JEWEL ON STAINLESS STEEL PLATED BRASS. JEWEL SHALL BE FINISHED WHERE INDICATED.
- F-11 GENERAL #1605, BRASS, PERFORATED, NO STEM, 150" FLOOR, 1.5 FT ONE PIECE STEM AS INDICATED & 150" FLOOR.
- F-12 LITECRAFT #8725, 300W, BRASS
- F-13 LITECRAFT #603 A, BRASS, WITH 150" SPOT LAMPS.
- F-14 EXHAUST FANS IN CEILING ROOMS SHALL BE ILE #150 SH, 1/2 HP 1500 RPM INSTALLED AS DIRECTED BY ARCHITECT.

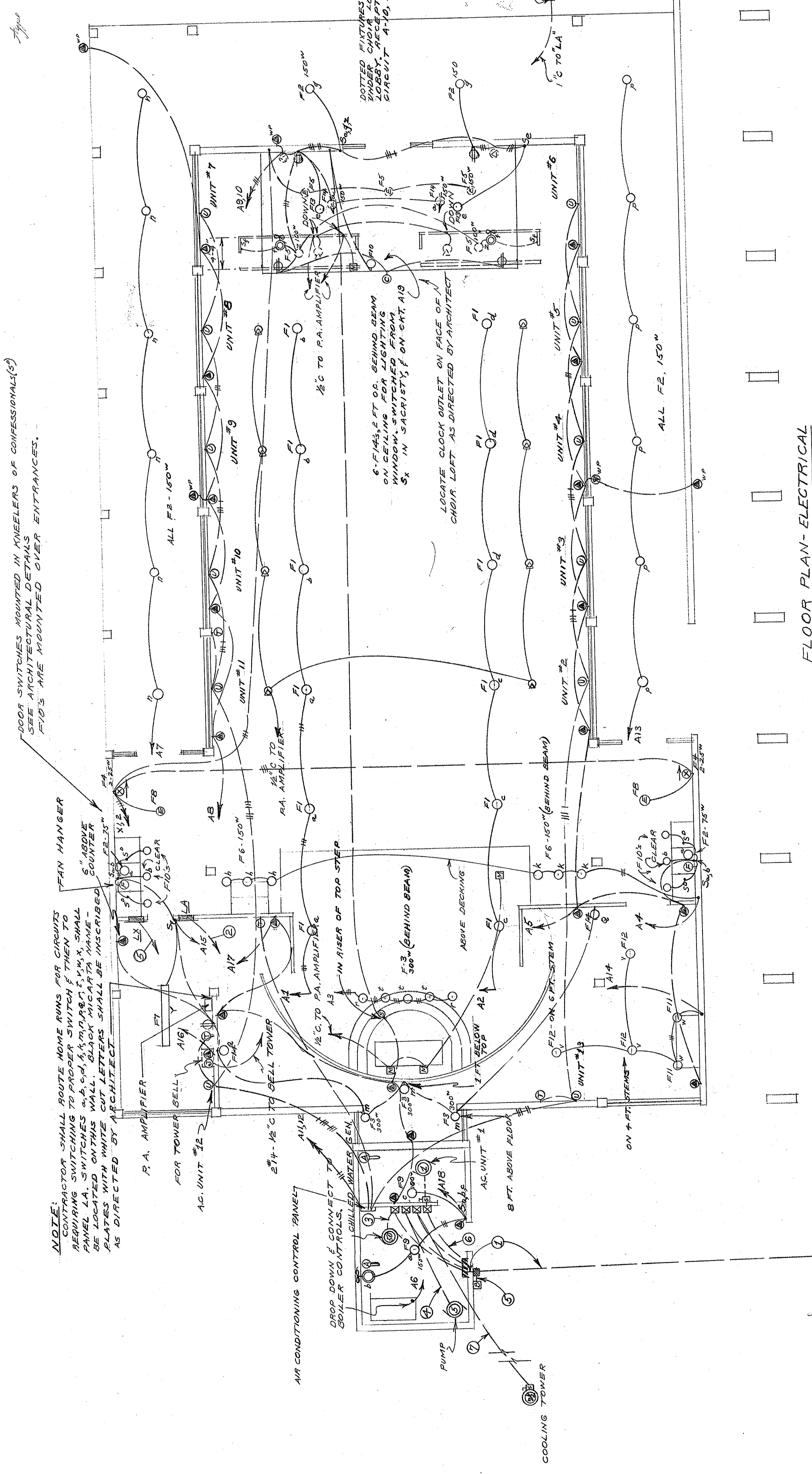

FLOOR PLAN-ELECTRICAL
SCALE: 1/8" = 1'-0"

NOTE:
SCHEDULES & DIAGRAM REMAIN AS THEY ARE SHOWN ON SHEET E-1000 UNLESS OTHERWISE NOTED.
EXCEPTION FOR 150 HP MOTOR SHALL BE EQUAL TO ALLEN-BRADLEY SULL. 236 PART WINDING STARTER.
AC UNIT #13, ITEM NO. B SHALL BE 150 HP UNIT.
IN LADIES CHAMBER, SINK & 20 AMP BREAKERS (11-19 & 73 AMPS) & PANEL ON PANEL CHAMBER 25-20 AMP BREAKERS (11-19 & 73 AMPS)

"CLECO" WILL PROVIDE 100 AMP 3Ø WIRE OVERHEAD MAIN SERVICE TO THIS BUILDING. LOCATION SHALL BE DETERMINED BY ARCHITECT APPROX. 60 FT. FROM BLDG.

REV: RELOCATED AC EQUIP. & REVISED ELECTRICAL LAYOUT

SACRED HEART CHURCH
PINEVILLE LOUISIANA
REV. PAUL E. CONWAY PASTOR

BARRON, BREINBERG & BROCATO ARCHITECTS
1015 WESTBURY ST. ALEXANDRIA, LOUISIANA
JOB NO. 733

WARREN G. MOSES
CONSULTING ENGINEER
1318 BURRAN STREET
ALEXANDRIA, LOUISIANA
733

DATE: _____
REVISED: _____
CHKD: _____
BY: _____

